

PRODUCT DETAILS: MODEL 4USB

Color:	White
Material:	ABS engineering plastic
Dimensions:	75 x 50 x 30 mm
Net Weight:	110 g
Input:	100-240 V, 50-60 Hz When using 2 USB ports, output 5 V 1500 mA When using 3 USB ports, output 5 V 1000 mA When using 4 USB ports, output 5 V 750 mA
Usage:	Charges devices using mains power via USB connectivity.
Output protection:	Automatic electronic short circuit protection and restoration.
Input Protection:	Fuse

FEATURE DIAGRAM

USB slots 1 and 2 work best for tablets. USB slots 3 and 4 work best for mobile phones and other devices. Note, all slots are suitable for all devices, although charge time may vary.

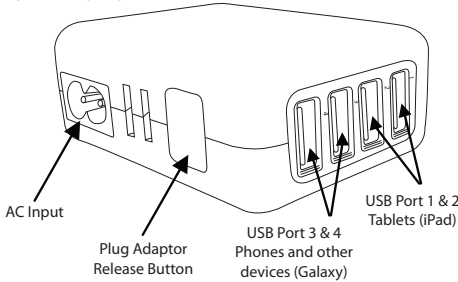

CAUTION

To prevent electric shock, do not expose the USB Adaptor to rain or moisture. The USB Adaptor is for indoor use only.
Do not operate with a damaged socket or plug.
Keep out of reach of children and uninformed persons.
Switch off mains and remove adaptor when not in use.

HOW TO CHARGE YOUR MOBILE DEVICE.

1. Insert the USB Power Adaptor into the mains socket.
2. Turn mains socket on.
3. Connect your device to the USB Power Adaptor using your USB cable. (Not supplied)
4. After charging your device, disconnect the items in reverse order.

Note: For the most efficient charge, it is advisable to charge devices with a total output of 3.1A or less at any given time.

INSTALLATION DIAGRAM

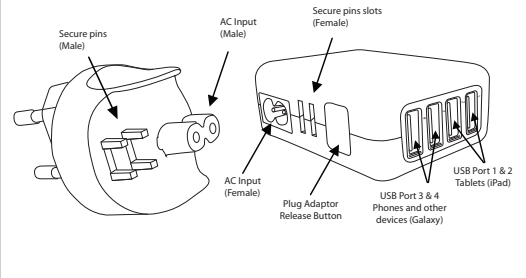

RECOMMENDED USB SLOTS

When charging one device, the full power output (3.1A) will be dedicated to that port. If charging two devices, the output will be shared at approximately 1.5 A; three devices approximately 1A and four devices 0.75 A per port.

Some devices charge more efficiently than others. For optimal use do not charge multiple high current drawing devices simultaneously. eg: Four tablets. Charge time will be increased. Typically tablets will require more current than mobile phones.

FEATURES

Blue LED lights indicates mains power is on.
Easy operation and portable.
Compatible with most devices.

CARE

1. Never open the USB Power Adaptor.
2. Ensure that there are no foreign bodies or material inside the USB slots.
3. Ensure sufficient airflow around the USB to prevent overheating.
4. Never force USB connectors into the USB slots, or pins into the mains sockets.
5. Ensure pins are secure and properly inserted into the mains socket.
6. To shut off power completely, remove the USB Power Adaptor from the mains socket.

TROUBLE SHOOTING

1. Check power supply is in working order.
2. That the plug pin adaptor is inserted correctly and securely into the USB charger as per the diagram.
3. That the adaptor is inserted correctly and securely into the mains socket and that the blue LED light illuminates.
4. That the USB cables are inserted correctly and show no signs of damage or obvious wear and tear.
5. USB cables are correctly inserted into the device.
6. That you are not attempting to charge too many high current drawing devices simultaneously. Devices should still charge, but will take a longer duration. ie: 4 x Tablets

Smart Zone Technology

Power Adaptor
Model 4USB
Instruction Leaflet